

Specifications

Voltage Rating : 250V AC/DC

Current Rating : 5A AC/DC

Withstanding Voltage : 1,500V AC/minute.

Insulation Resistance : 1,000 MΩ min.

Temperature Range : -25°C ~ +85°C

Contact Resistance : Initial value / 1 mΩ max.

after environmental testing / 20 mΩ max.

Contact Material : Brass

Insulator Material : Nylon-66, UL 94V-0 (White)

Finish : Tin plated

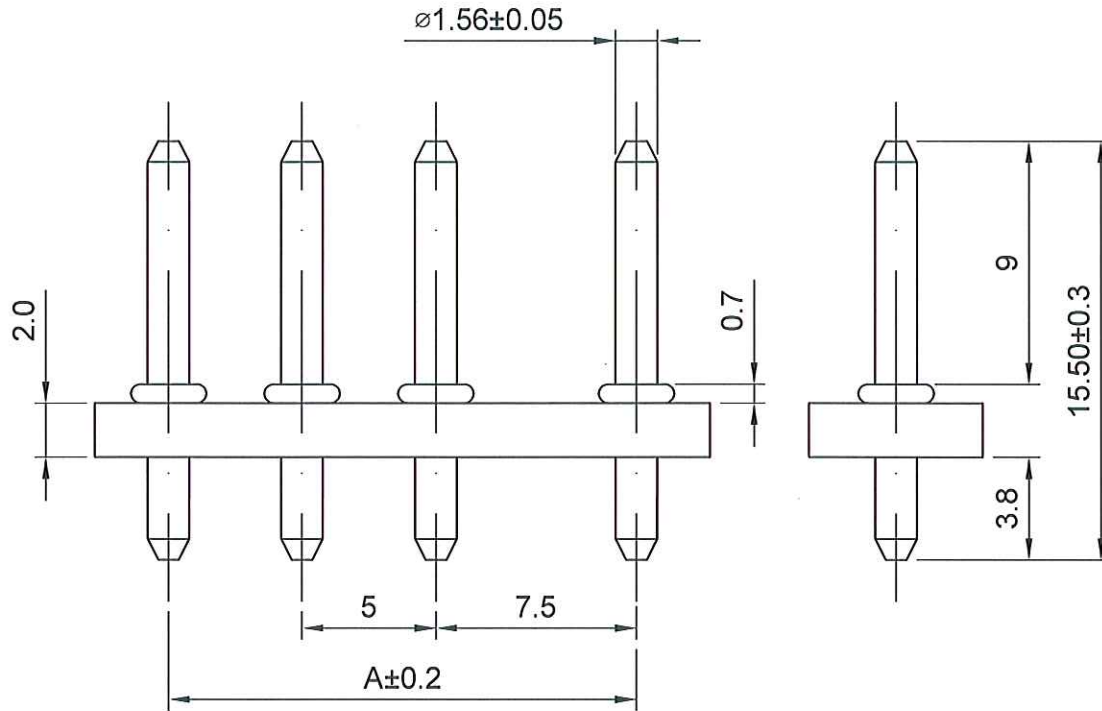

PARTS NO.	A	B
4155A-WS-01T	-	5.00
4155A-WS-02T	7.50	13.00
4155A-WS-03T	12.5	18.00
4155A-WS-04T	17.5	23.00
4155A-WS-05T	22.50	28.00
4155A-WS-06T	27.50	33.00

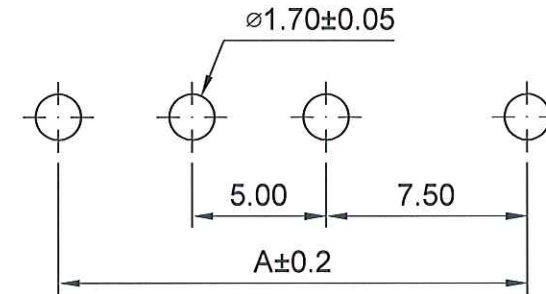

Recommended P.C.B. Layout